



SWING CHECK VALVES WAFER TYPE

SERIES
ZRK | ZRKF | 920

AWS
APPARATEBAU

TABLE OF CONTENTS

SWING CHECK VALVES WAFER TYPE

04 GENERAL DESCRIPTION

04 OVERVIEW MATRIX

05 WHY CHOOSE AWS?

TECHNICAL DATA

06 SERIES ZRK

10 SERIES ZRKF

14 SERIES 920

18 SPECIAL OPTIONS

20 TYPE CODE

21 QUALITY AT AWS

22 AWS PRODUCT OVERVIEW

Publisher

AWS Apparatebau Arnold GmbH
Zimmerbachstraße 51
74676 Niedernhall - Waldzimmern

Tel.: +49 (0)7940 9308-200
info@aws-apparatebau.de
www.aws-apparatebau.de

Status:

07/2022

Pictures:

© Shutterstock Inc.
© Screengallery.de
© AWS Apparatebau Arnold GmbH

Design:

RSB Design GmbH

Note

Although the data shown in this catalogue has been carefully checked, we do not accept any liability for any incorrect or incomplete information.

We reserve the right to make technical changes.

No part of this document may be reproduced or transmitted in any form or by any means without prior written permission. Depictions may differ from the actual items supplied.

GENERAL DESCRIPTION

SWING CHECK VALVES WAFER TYPE



Description and intended purpose

AWS swing check valves wafer type are characterized by their simple and robust design. A key feature is their particularly narrow FTF length - a major advantage compared to other designs in many installation situations in piping systems in industrial and building services. They can be installed directly between flanges (PN 6 - PN 40 or Class 150 - Class 300).

AWS swing check valves wafer type are maintenance-free.

Function

AWS swing check valves wafer type require a low opening pressure. The resulting opening force pushes the disc against its self-weight and, if necessary, also an additional spring, so that the medium can flow. If the inlet pressure drops or if the backpressure exceeds the inlet pressure, the valve closes and seals against the medium by means of the soft seat or the metal seat.

WHY CHOOSE AWS

SWING CHECK VALVES WAFER TYPE?

IN BRIEF:

Many years of experience in the production of check valves

In-house assembly department with maximum flexibility and expertise

Advice and technical design via in-house design and engineering team

High availability ensuring short delivery times of standard articles

QUALITY AND TESTING AT AWS:

Own test benches for pressure and leak tests in accordance with EN 12266-1, API 598 and other common standards

Experience and routine in the preparation of works and acceptance test certificates in accordance with DIN EN 10204 (2.2, 3.1 or 3.2 certificate)

Regular auditing of processes and quality mechanisms by TÜV Süd, discerning customers and other external bodies

In-house spectral analyses for metallic materials

Additional quality assurance measures (external and internal), for example corrosion testing, dye penetrant testing, X-ray testing, preparation of QCPs, etc.

OVERVIEW MATRIX

SWING CHECK VALVES WAFER TYPE

DESCRIPTION

	ZRK	ZRKF	920	925.1	
NOMINAL SIZES*1	DN 32 - DN 1000	DN 32 - DN 400	DN 32 - DN 600	DN 50 - DN 200	
FLANGE CONNECTION*2	PN 6 / PN 10 / PN 16 / PN 25 / PN 40 Class 150 / Class 300 JIS 10K	PN 6 / PN 10 / PN 16 / PN 25 / PN 40 Class 150 / Class 300 JIS 10K	PN 6 / PN 10 Class 150 JIS 10K	PN 10	
MAX. PRESSURE	16 to 50 bar*3	16 to 50 bar*3	10 bar	6 bar	
TEMPERATURE RANGES	-273 °C to +500 °C	-200 °C to +450 °C	-20 °C to +120 °C	0 °C to +50 °C	
MATERIALS AVAILABLE*5	Steel	x	x	-	
	Stainless steel	x	x	-	
	Alu-Bronze	x	x	-	-
	Superduplex	x	x	-	-
	PVC	-	-	x	x
	PP	-	-	x	-
	PVDF	-	-	x	-
SEALS AVAILABLE	Metal, NBR, EPDM, FKM, PTFE	Metal, NBR, EPDM, FKM, PTFE	NBR, EPDM, FKM, PTFE	EPDM	

*1 other nominal sizes on request

*2 other flange connections on request

*3 depending on nominal size and design

*4 other materials on request

... AND BECAUSE WE KNOW

WHAT MATTERS IN YOUR INDUSTRY!



TECHNICAL DATA

SWING CHECK VALVE WAFER TYPE | SERIES ZRK

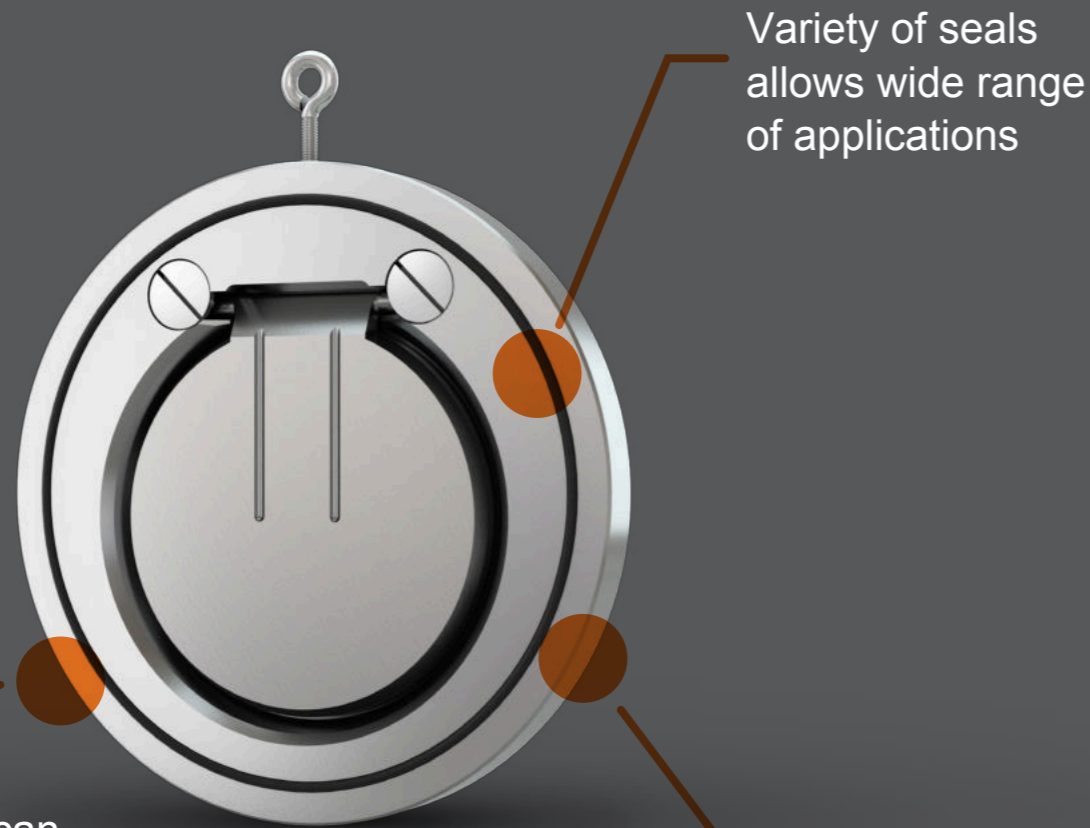

Variety of seals allows wide range of applications

Special options can be realised at short notice

High operating pressures just as short FTF



Nominal sizes

DN 32 - DN 1000

Flange connection

PN 6 - PN 40 | Class 150 - 300 | JIS 10K

Max. pressure:

16 to 50 bar

Temperature range

-273 °C to +500 °C

TECHNICAL DATA

SWING CHECK VALVE WAFER TYPE | SERIES ZRK



1. Body

2. Disc

3. Disc holder

4. Seals

Design	Body	Disc	Max. allowable pressure*1				
			DN 32 - 40 40 bar	DN 50 25 bar	DN 65 - 1000 16 bar	DN 125 - 1000 16 bar	
ST-ST	1.0460, zinc plated	1.0619 / 1.0460, zinc plated	DN 32 - 40 40 bar	DN 50 25 bar	DN 65 - 1000 16 bar	DN 125 - 1000 16 bar	
ST-VA	1.0460, zinc plated	1.4408	DN 32 - 40 40 bar	DN 50 25 bar	DN 65 - 1000 16 bar	DN 125 - 1000 16 bar	
VA-VA	1.4408	1.4408	DN 32 - 50 40 bar	DN 65 30 bar	DN 80 - 100 20 bar	DN 125 - 1000 16 bar	
VA1-VA1	1.4571	1.4571	DN 32 - 50 50 bar	DN 65 40 bar	DN 80 30 bar	DN 100 - 150 25 bar	DN 200 - 1000 20 bar
AB-DU	CC333G (2.0975)	1.4469 (Superduplex)	DN 32 - 50 40 bar	DN 65 - 125 30 bar	DN 150 - 300 20 bar	DN 350 - 1000 10 bar	
DU-DU	1.4469 (Superduplex)	1.4469 (Superduplex)	DN 32 - 65 50 bar	DN 80 - 100 40 bar	DN 125 - 150 30 bar	DN 200 - 1000 20 bar	

*1 max. allowable pressure is dependent on the temperature

Seal	Design	Temperature	Leakage rate*2
Metal seated*3	ST-VA	-10 °C to +400 °C	G
	VA-VA	-196 °C to +400 °C	
	VA1-VA1	-273 °C to +500 °C	
	AB-DU	-10 °C to +250 °C	
	DU-DU	-10 °C to +250 °C	
NBR*4	-	-30 °C to +100 °C	A
EPDM*4	-	-65 °C to +150 °C	A
FKM*4	-	-30 °C to +230 °C	A
PTFE*4	-	-200 °C to +250 °C	A

*2 acc. to EN 12266-1

*3 metal seated valves are supplied without O-rings in body as standard

*4 for some designs, the temperature range is additionally limited by the temperature range of the metallic parts (see temperature range for metal seated)

Seals for valves up to and including DN 300 comply with the following approvals / conformities:

NBR: DIN EN 549, BAM, REACH, RoHS etc.

EPDM: KTW UBA, DVGW W 270, WRAS, NSF, FDA, BfR XXI Kat. 4, ADI-free, 3A, USP Cl. 6, BAM, REACH, RohS etc.

FKM: DIN EN 549, ADI-free, REACH, RoHS etc.

PTFE: KTW UBA, DVGW W 270, WRAS, FDA, BfR, ADI-free, EU 10/2011, 3A, USP Cl. 6, REACH, RoHS etc.

TECHNICAL DATA

SWING CHECK VALVE WAFER TYPE | SERIES ZRK

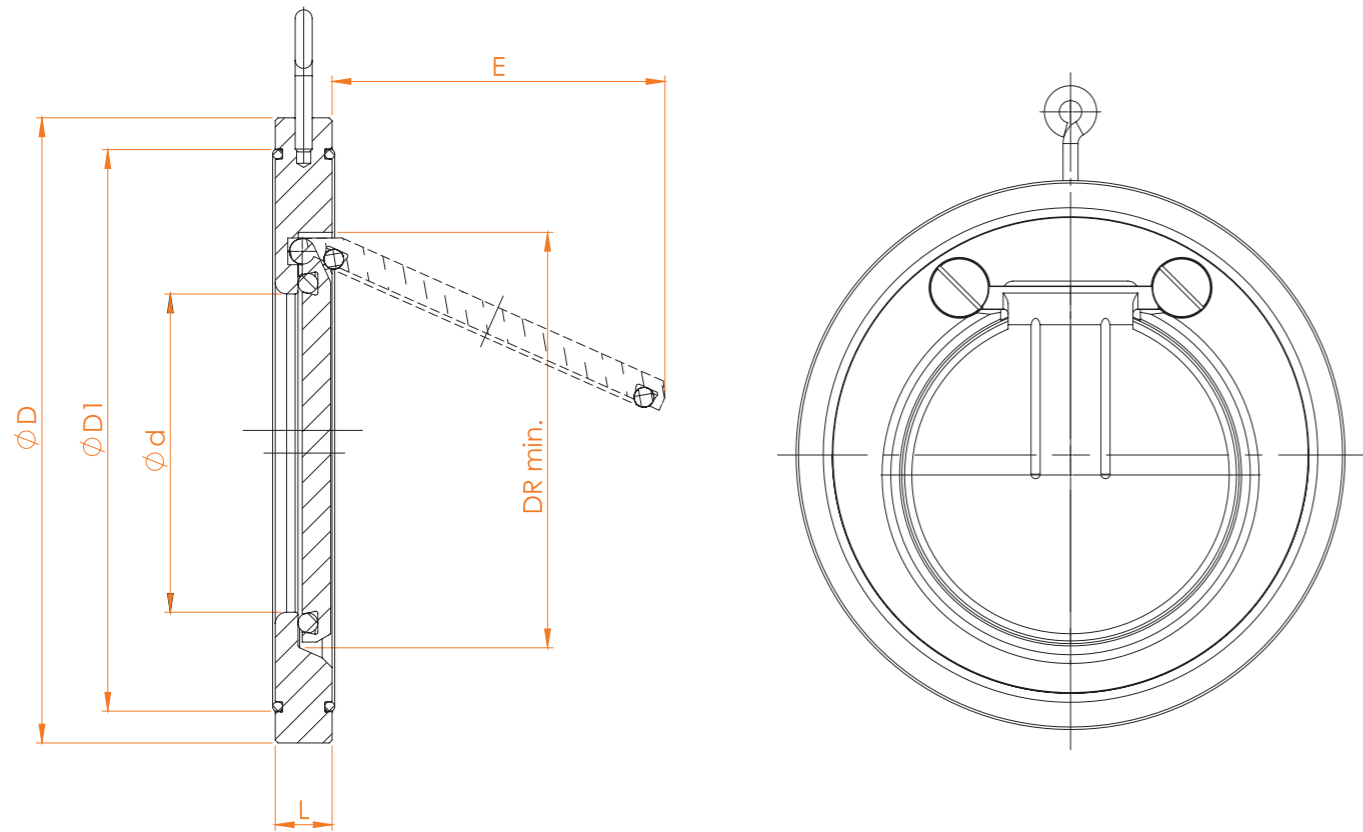

Nominal size	Ø D*5								L	Ø d	Ø D1	E	DR	Kv value [m³/h]	Opening pressure [mbar]		Weight*6 [kg]
	PN 6	PN 10	PN 16	PN 25	PN 40	ANSI 150	ANSI 300	JIS 10K							↔	↑	
DN 32	79	85	85	85	85	74	85	85	15	18	59	22	37	16,2	~ 2	~ 10	0,67
DN 40	89	95	95	95	95	83	95	91	16	22	72	25	43	22,2	~ 2	~ 10	0,85
DN 50	98	109	109	109	109	105	112	105	14	32	86	37	54	54	~ 2	~ 10	0,91
DN 65	118	129	129	129	129	124	129	124	14	40	109	50	70	75	~ 2	~ 10	1,2
DN 80	134	144	144	144	144	137	150	135	14	54	119	61	82	112	~ 2	~ 10	1,5
DN 100	154	164	164	170	170	175	181,5	160	18	70	146	77	106	172	~ 2	~ 10	2,4
DN 125	184	195	195	196	196	197	216,5	191	18	92	173	98	131	342	~ 2	~ 10	3,4
DN 150	209	220	220	226	226	222	251,5	220	20	112	197	120	159	490	~ 2	~ 10	4,7
DN 200	264	275	275	286	294	279	308	271	22	154	255	160	207	1128	~ 4	~ 14	7,7
DN 250	319	330	331	344	356	340	362	330	26	192	312	190	260	1500	~ 4	~ 14	13
DN 300	375	380	386	404	421	410	423	380	32	227	363	220	309	2290	~ 4	~ 14	21
DN 350	425	440	446	461	478	451	487	424	38	266	416	250	341	2890	~ 6	~ 18	33
DN 400	475	491	499	518	550	514	541	487	44	310	467	290	392	3700	~ 6	~ 18	46
DN 450	530	541	558	568	575	549	598	541	52	350	520	340	442	5000	~ 6	~ 18	67
DN 500	580	596	621	628	632	606	655	596	58	400	550	390	493	6550	~ 6	~ 24	89
DN 600	681	698	738	735	751	718	775	698	62	486	660	470	594	9550	~ 6	~ 26	128
DN 700	785	813	807	836	-	-	-	-	67	588	770	563	693	23000	~ 6	~ 26	190
DN 800	893	920	914	945	-	-	-	-	78	622	-	680	795	38000	~ 6	~ 30	292
DN 900	993	1020	1014	1045	-	-	-	-	95	720	-	750	889	60000	~ 6	~ 32	412
DN 1000	1093	1127	1131	1159	-	-	-	-	105	810	-	840	991	80000	~ 6	~ 36	550

*5 in order to realise the flange connection diameters, flange center-rings may be used

*6 weight refers to valve suitable for PN 10 flanges and may vary slightly, depending on the design

TECHNICAL DATA

SWING CHECK VALVE WAFER TYPE | SERIES ZRK

Pressure-Loss Diagram Type ZRK

The diagram values are valid for water at a temperature of 20 °C and for valves with face-to-face dimensions in accordance with DIN EN 558, suitable for flanges in accordance with PN 10 - PN 40. At the opening of the valve, the curves apply to operation in horizontal pipelines. For calculations for other fluids or temperatures, please contact us.

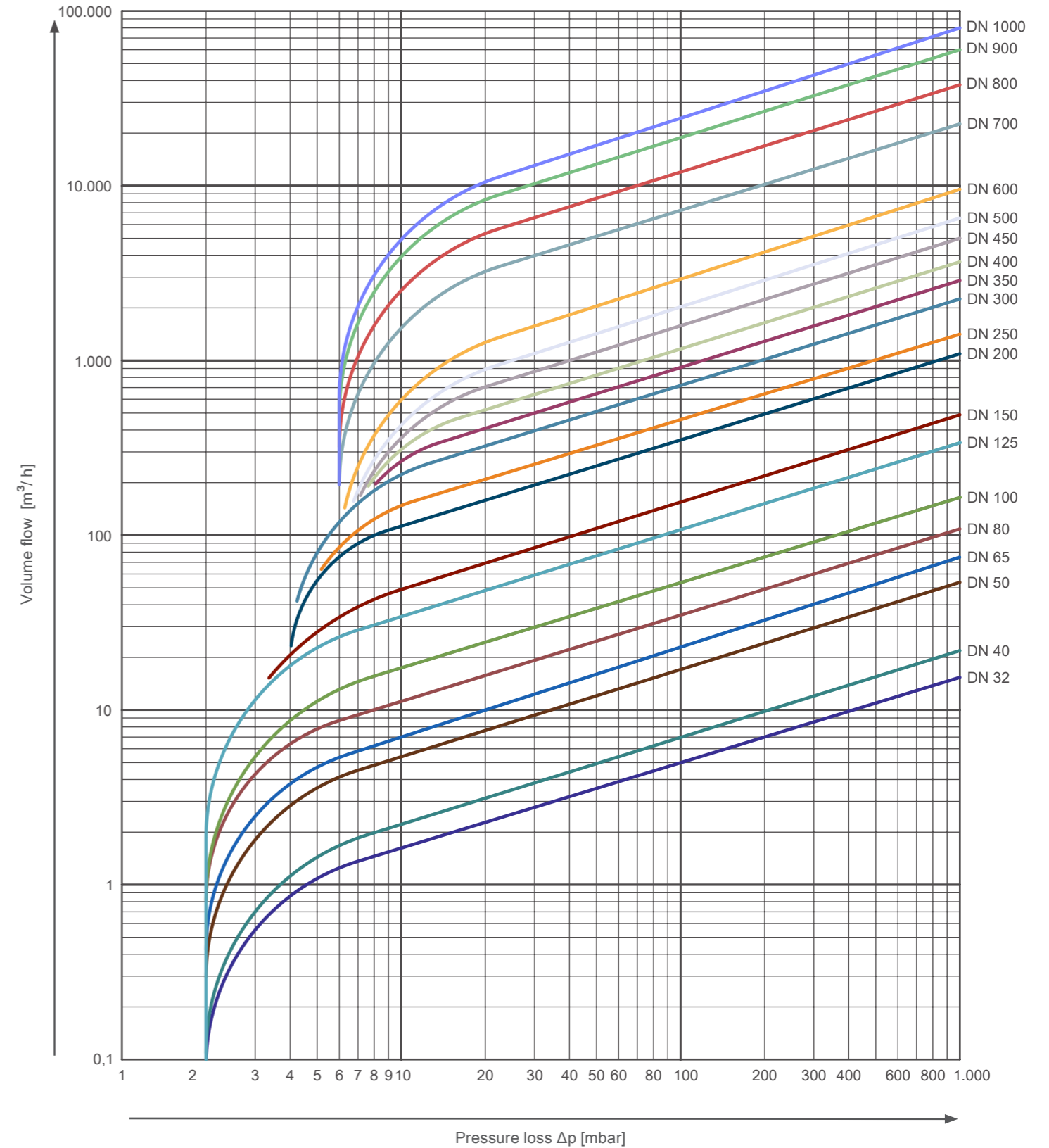

TECHNICAL DATA

SWING CHECK VALVE WAFER TYPE | SERIES ZRKF

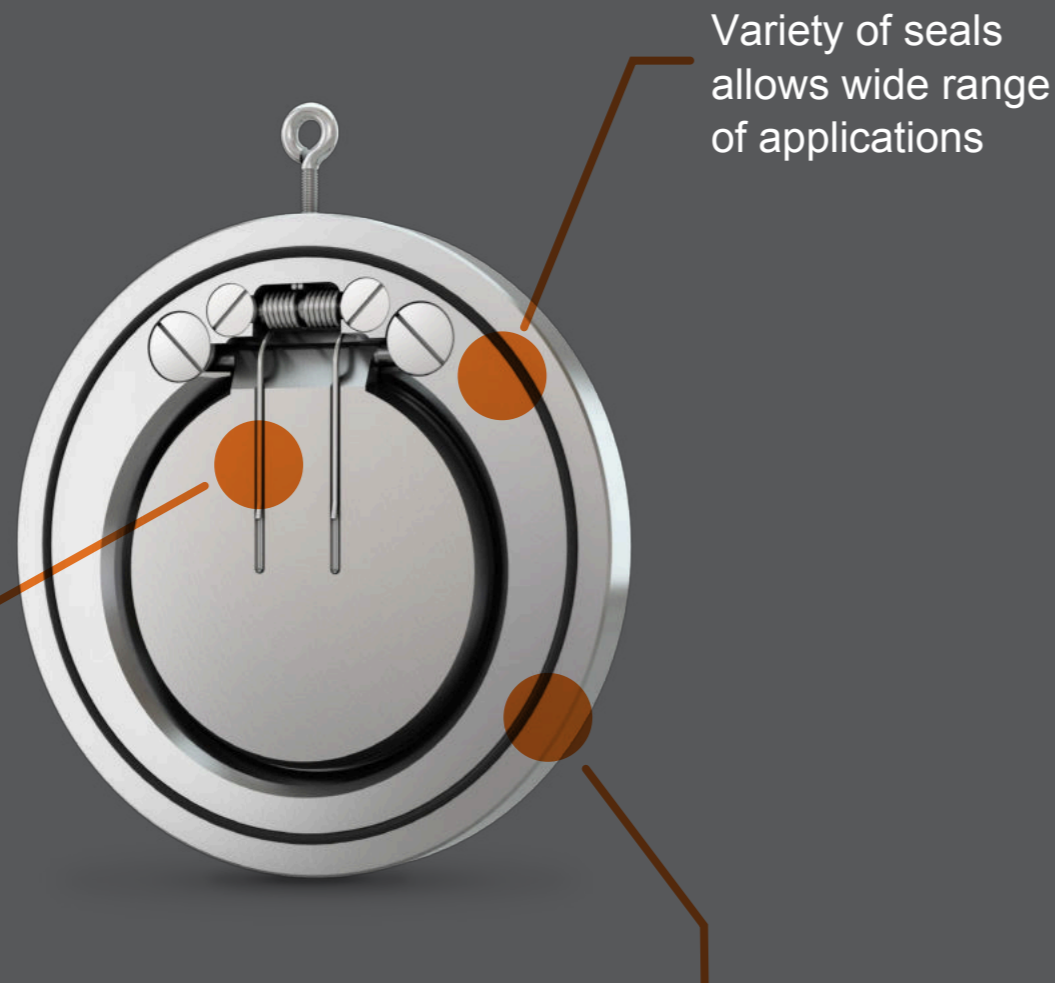

Variety of seals allows wide range of applications

Stable closing performance due to return spring

High operating pressures just as short FTF



Nominal sizes

DN 32 - DN 400

Flange connection

PN 6 - PN 40 | Class 150 - 300 | JIS 10K

Max. Pressure

16 to 50 bar

Temperature range

-200 °C to +450 °C

TECHNICAL DATA

SWING CHECK VALVE WAFER TYPE | SERIES ZRKF



1. Body

2. Disc

3. Disc holder

4. Spring

5. Seals

Design	Body	Disc	Spring	Max. allowable pressure*1			
				DN 32 - 40 40 bar	DN 65 30 bar	DN 80 - 100 20 bar	DN 125 - 400 16 bar
ST-ST	1.0460, zinc plated	1.0619 / 1.0460, zinc plated	1.4571	DN 32 - 40 40 bar	DN 65 30 bar	DN 80 - 100 20 bar	DN 125 - 400 16 bar
ST-VA	1.0460, zinc plated	1.4408	1.4571	DN 32 - 40 40 bar	DN 65 30 bar	DN 80 - 100 20 bar	DN 125 - 400 16 bar
VA-VA	1.4408	1.4408	1.4571	DN 32 - 50 40 bar	DN 65 30 bar	DN 80 - 100 20 bar	DN 125 - 400 16 bar
VA1-VA1	1.4571	1.4571	1.4571	DN 32 - 50 50 bar	DN 65 40 bar	DN 80 30 bar	DN 100 - 150 25 bar DN 200 - 400 20 bar
AB-DU	CC333G (2.0975)	1.4469 (Superduplex)	Hastelloy C4 (2.4610)	DN 32 - 50 40 bar	DN 65 - 125 30 bar	DN 150 - 300 20 bar	DN 350 - 400 10 bar
DU-DU	1.4469 (Superduplex)	1.4469 (Superduplex)	Hastelloy C4 (2.4610)	DN 32 - 65 50 bar	DN 80 - 100 40 bar	DN 125 - 150 30 bar	DN 200 - 400 20 bar

*1 max. allowable pressure is dependent on the temperature

Seal	Design	Temperature	Leakage rate*2
Metal seated*3	ST-VA	-10 °C to +300 °C*4	G
	VA-VA	-196 °C to +300 °C*5	
	VA1-VA1	-200 °C to +300 °C*6	
	AB-DU	-10 °C to +250 °C	
	DU-DU	-10 °C to +250 °C	
NBR*7	-	-30 °C to +100 °C	A
EPDM*7	-	-65 °C to +150 °C	A
FKM*7	-	-30 °C to +230 °C	A
PTFE*7	-	-200 °C to +250 °C	A

*2 acc. to EN 12266-1

*3 metal seated valves are supplied without O-rings in body as standard

*4 optional with spring made of Hastelloy C4: -10 °C to +450 °C

*5 optional with spring made of Hastelloy C4: -100 °C to +400 °C

*6 optional with spring made of Hastelloy C4: -100 °C to +450 °C

*7 for some designs, the temperature range is additionally limited by the temperature range of the metallic parts (see temperature range for metal seated)

Seals for valves up to and including DN 300 comply with the following approvals / conformities:

NBR: DIN EN 549, BAM, REACH, RoHS etc.

EPDM: KTW UBA, DVGW W 270, WRAS, NSF, FDA, BfR XXI Kat. 4, ADI-free, 3A, USP Cl. 6, BAM, REACH, RohS etc.

FKM: DIN EN 549, ADI-free, REACH, RoHS etc.

PTFE: KTW UBA, DVGW W 270, WRAS, FDA, BfR, ADI-free, EU 10/2011, 3A, USP Cl. 6, REACH, RoHS etc.

TECHNICAL DATA

SWING CHECK VALVE WAFER TYPE | SERIES ZRKF

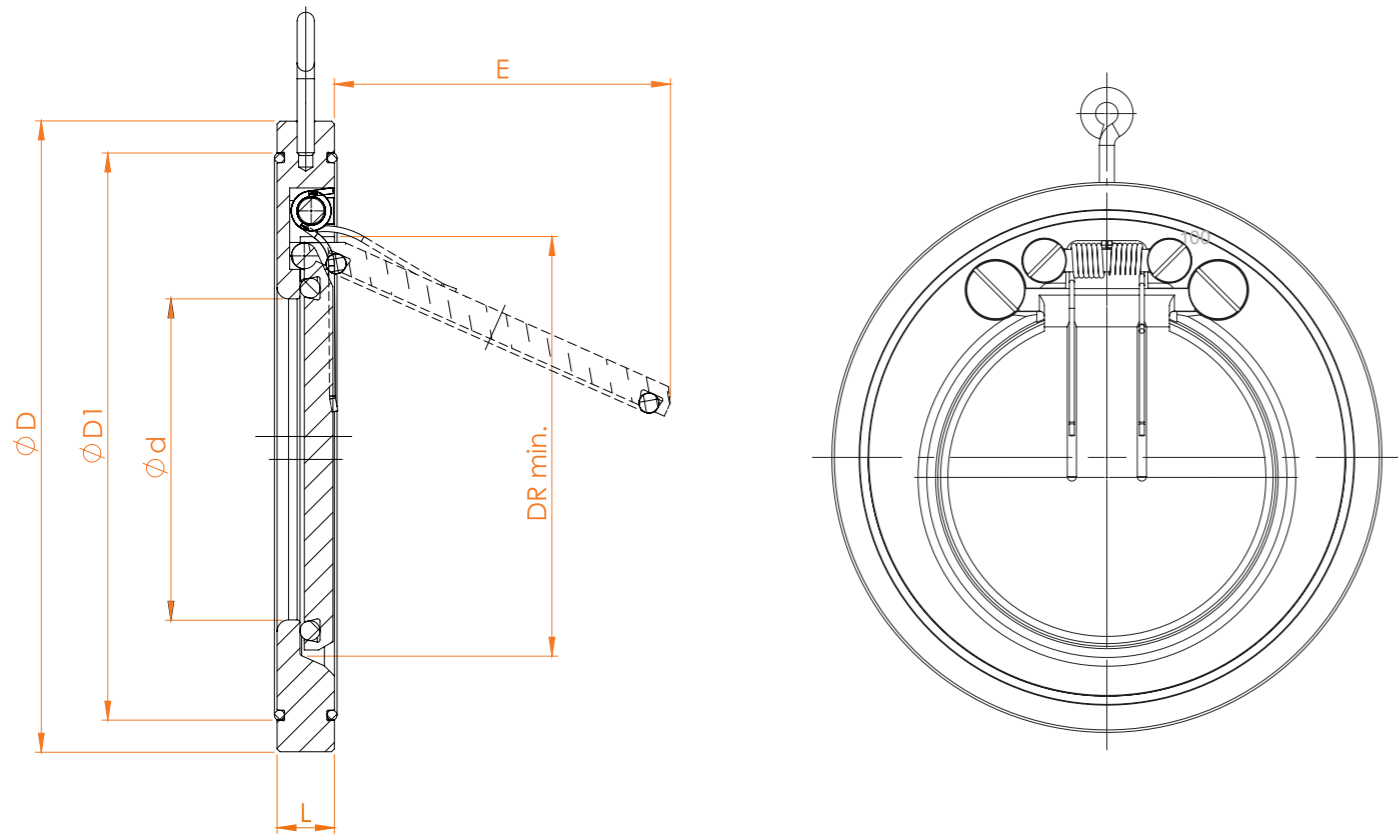

Nominal size	Ø D ^{*8}								L	Ø d	Ø D1	E	DR	Kv value [m ³ /h]	Opening pressure [mbar]		Weight ^{*9} [kg]
	PN 6	PN 10	PN 16	PN 25	PN 40	ANSI 150	ANSI 300	JIS 10K							↔	↑	
DN 32	79	85	85	85	85	74	85	85	15	18	59	22	37	16,2	~ 15	~ 25	0,67
DN 40	89	95	95	95	95	83	95	91	16	22	72	25	43	22,2	~ 15	~ 25	0,85
DN 50	98	109	109	109	109	105	112	105	14	32	86	37	54	54	~ 15	~ 25	0,91
DN 65	118	129	129	129	129	124	129	124	14	40	109	50	70	75	~ 15	~ 25	1,2
DN 80	134	144	144	144	144	137	150	135	14	54	119	61	82	112	~ 15	~ 25	1,5
DN 100	154	164	164	170	170	175	181,5	160	18	70	146	77	106	172	~ 15	~ 25	2,4
DN 125	184	195	195	196	196	197	216,5	191	18	92	173	98	131	342	~ 15	~ 25	3,4
DN 150	209	220	220	226	226	222	251,5	220	20	112	197	120	159	490	~ 15	~ 25	4,7
DN 200	264	275	275	286	294	279	308	271	22	154	255	160	207	1128	~ 17	~ 25	7,7
DN 250	319	330	331	344	356	340	362	330	26	192	312	190	260	1500	~ 17	~ 25	13
DN 300	375	380	386	404	421	410	423	380	32	227	363	220	309	2290	~ 17	~ 25	21
DN 350	425	440	446	461	478	451	487	424	38	266	416	250	341	2890	~ 18	~ 27	33
DN 400	475	491	499	518	550	514	541	487	44	310	467	290	392	3700	~ 18	~ 28	46

^{*8} in order to realise the flange connection diameters, flange center-rings may be used

^{*9} weight refers to valve suitable for PN 10 flanges and may vary slightly, depending on the design

TECHNICAL DATA

SWING CHECK VALVE WAFER TYPE | SERIES ZRKF

Pressure-Loss Diagram Type ZRKF

The diagram values are valid for water at a temperature of 20 °C and for valves with face-to-face dimensions in accordance with DIN EN 558, suitable for flanges in accordance with PN 10 - PN 40. At the opening of the valve, the curves apply to operation in horizontal pipelines. For calculations for other fluids or temperatures, please contact us.

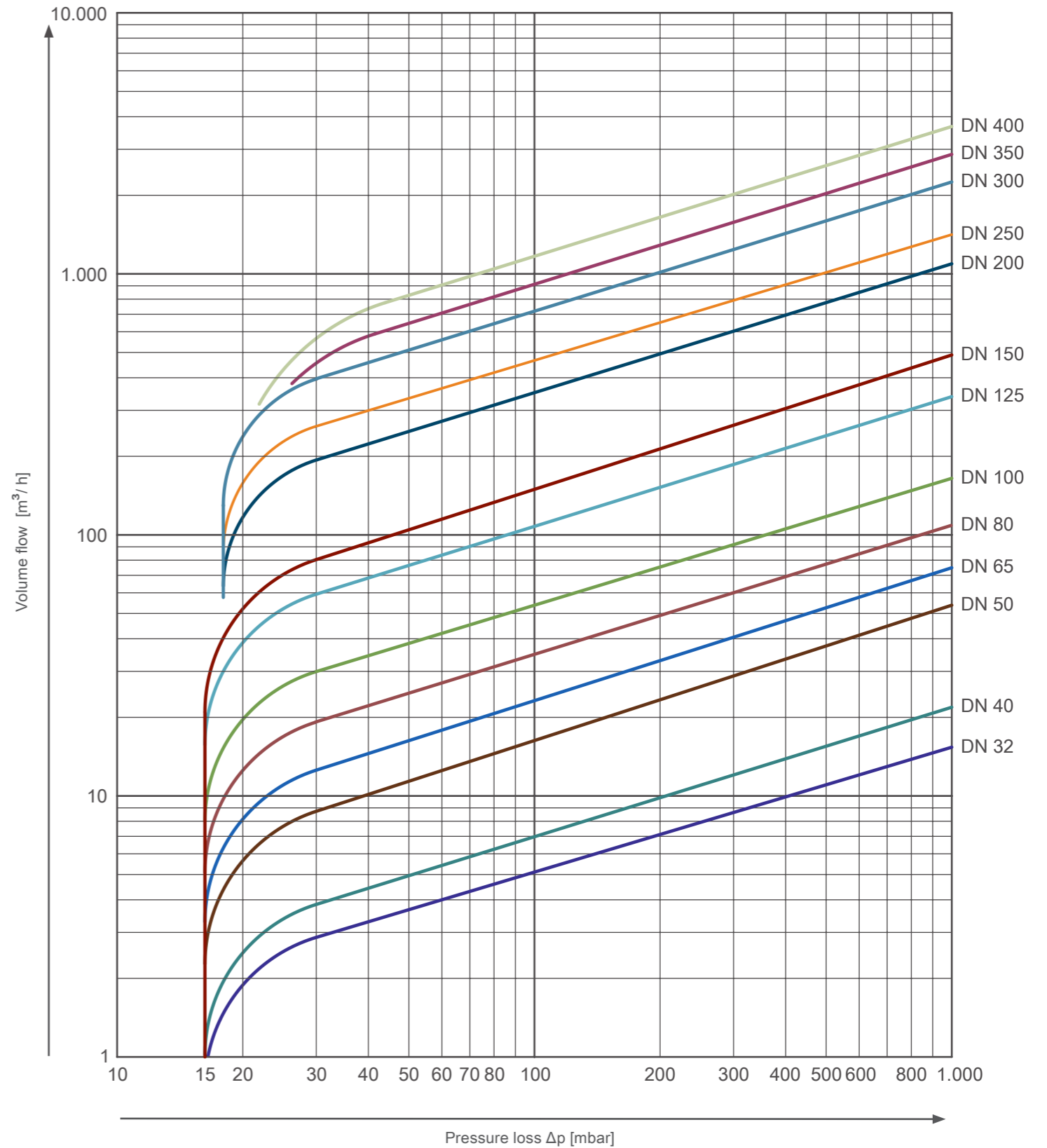

TECHNICAL DATA

SWING CHECK VALVE WAFER TYPE | SERIES 920

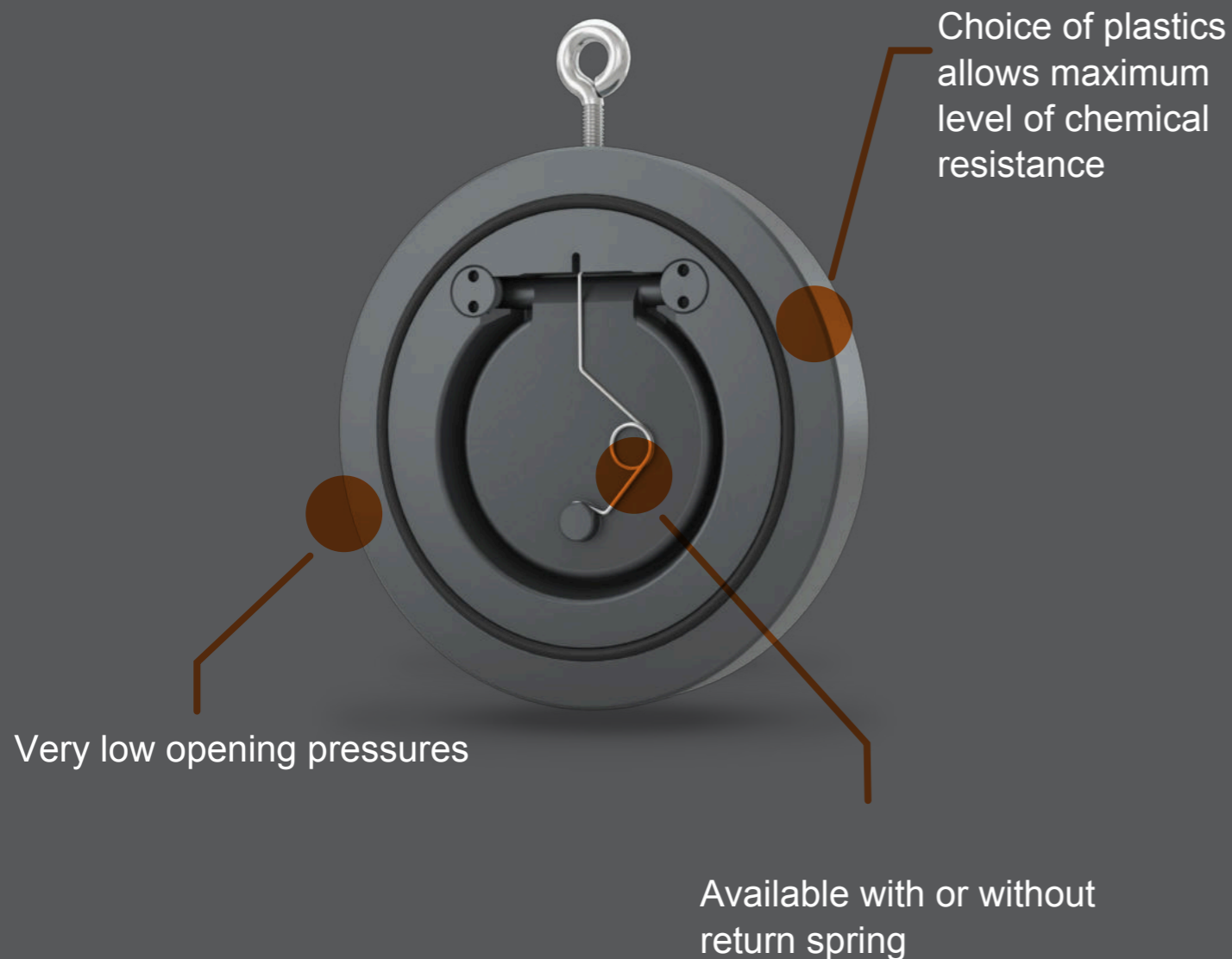

Nominal sizes

DN 32 - DN 600

Flange connection

PN 6 / PN 10 | Class 150 | JIS 10K

Max. pressure

10 bar

Temperature range

-20 °C to +120 °C

TECHNICAL DATA

SWING CHECK VALVE WAFER TYPE | SERIES 920



1. Body

2. Disc

3. Disc holder

4. Spring

5. Seals

Design	Body	Disc	Spring*1	Max. allowable pressure**2,3		
				DN 32 - 125 10 bar	DN 150 - 200 6 bar	DN 250 - 600 5 bar
4	PVC-U	PVC-U	1.4571, Hastelloy C4 (2.4610)	DN 32 - 125 10 bar	DN 150 - 200 6 bar	DN 250 - 600 5 bar
4.1	PVC-C	PVC-C	1.4571, Hastelloy C4 (2.4610)	DN 32 - 125 10 bar	DN 150 - 200 6 bar	DN 250 - 600 5 bar
5	PP-H	PP-H	1.4571, Hastelloy C4 (2.4610)	DN 32 - 65 8 bar	DN 80 - 200 6 bar	DN 250 - 600 5 bar
8	PVDF	PVDF	1.4571, Hastelloy C4 (2.4610)	DN 32 - 125 10 bar	DN 150 - 200 8 bar	DN 250 - 600 5 bar

*1 for the choice of the appropriate spring material, the chemical resistance against the media has to be regarded

** max. allowable pressure is dependent on the temperature

**3 Values are valid for pressure in flow direction; If pressure against the closed disc (back pressure) occurs, it has to be limited for some nominal sizes and designs. For further information, see data sheet.

Seal	Temperature				Leakage rate**4
	PVC-U	PVC-C	PP-H	PVDF	
NBR	0 °C to +60 °C	0 °C to +80 °C	0 °C to +90 °C	-20 °C to +100 °C	A
EPDM				-20 °C to +120 °C	
FKM				-20 °C to +120 °C	
PTFE				-20 °C to +120 °C	

**4 acc. to EN 12266-1

Seals for valves up to and including DN 300 comply with the following approvals / conformities:

NBR: DIN EN 549, BAM, REACH, RoHS etc.

EPDM: KTW UBA, DVGW W 270, WRAS, NSF, FDA, BfR XXI Kat. 4, ADI-free, 3A, USP Cl. 6, BAM, REACH, RohS etc.

FKM: DIN EN 549, ADI-free, REACH, RoHS etc.

PTFE: KTW UBA, DVGW W 270, WRAS, FDA, BfR, ADI-free, EU 10/2011, 3A, USP Cl. 6, REACH, RoHS etc.

TECHNICAL DATA

SWING CHECK VALVE WAFER TYPE | SERIES 920

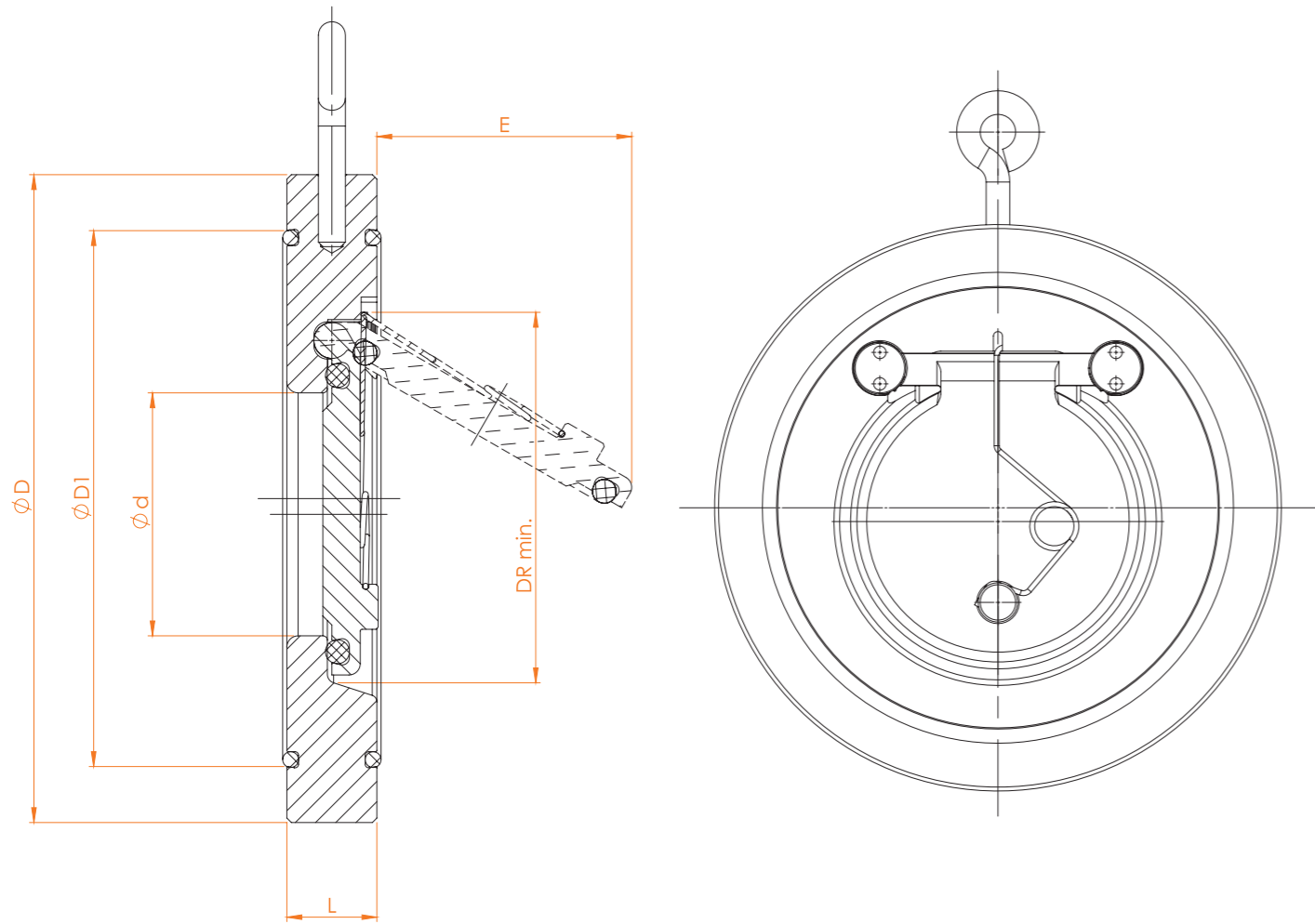

Nominal size	Ø D*5				L		Ø d	Ø D1	E	DR	Kv value [m³/h]	Opening pressure*6 [mbar]		Weight [kg]		
	PN 6	PN 10	ANSI 150	JIS 10K	without Spring	with Spring						↔	↑	PVC	PP-H	PVDF
DN 32	79	85	74	85	15	15	18	59	22	37	16,2	~ 0,2	~ 2	0,12	0,09	0,16
DN 40	89	95	83	91	16	16	22	72	25	43	22,2	~ 0,2	~ 2	0,16	0,11	0,19
DN 50	98	109	105	105	18	18	32	86	37	54	54	~ 0,2	~ 3	0,22	0,15	0,27
DN 65	118	129	124	124	20	20	40	105	50	70	75	~ 0,2	~ 3	0,33	0,22	0,42
DN 80	134	144	137	135	20	20	54	119	61	82	112	~ 0,2	~ 3	0,39	0,26	0,50
DN 100	154	164	175	160	23	23	70	146	77	106	172	~ 0,2	~ 3	0,57	0,37	0,72
DN 125	184	195	197	191	23	23	92	173	94	131	342	~ 0,2	~ 3	0,78	0,50	0,99
DN 150	209	220	222	220	26	26	105	197	100	159	490	~ 0,2	~ 3	1,1	0,72	1,4
DN 200	264	275	279	271	34	34	154	255	152	207	1128	~ 0,2	~ 4	2,1	1,4	2,7
DN 250	319	330	340	334	40	40	192	312	180	260	1500	~ 0,2	~ 4	3,5	2,2	4,4
DN 300	375	380	410	380	45	45	227	363	215	309	1914	~ 0,2	~ 4	5,1	3,2	6,5
DN 350	425	440	451	424	49	49	266	416	245	341	2800	~ 0,2	~ 5	7,7	5,0	9,8
DN 400	475	491	514	487	65	65	310	467	285	392	3700	~ 0,3	~ 7	12,6	8,1	16,1
DN 450	530	541	549	541	68	78	350	520	330	443	4500	~ 0,3	~ 8	17,7	11,2	22,5
DN 500	580	596	606	596	78	87	400	550	385	493	5450	~ 0,3	~ 8	23,5	15,0	30,2
DN 600	681	698	718	698	97	109	486	659	470	595	6800	~ 0,4	~ 11	39,9	25,4	50,8

*5 in order to realise the flange connection diameters, flange center-rings may be used
 *6 values for design without spring; opening pressure for valves with spring is approx. 2 mbar higher

TECHNICAL DATA

SWING CHECK VALVE WAFER TYPE | SERIES 920

Pressure-Loss Diagram Type 920

The diagram values are valid for water at a temperature of 20 °C and for valves with face-to-face dimensions in accordance with DIN EN 558, suitable for flanges in accordance with PN 10 - PN 40. At the opening of the valve, the curves apply to operation in horizontal pipelines. For calculations for other fluids or temperatures, please contact us.

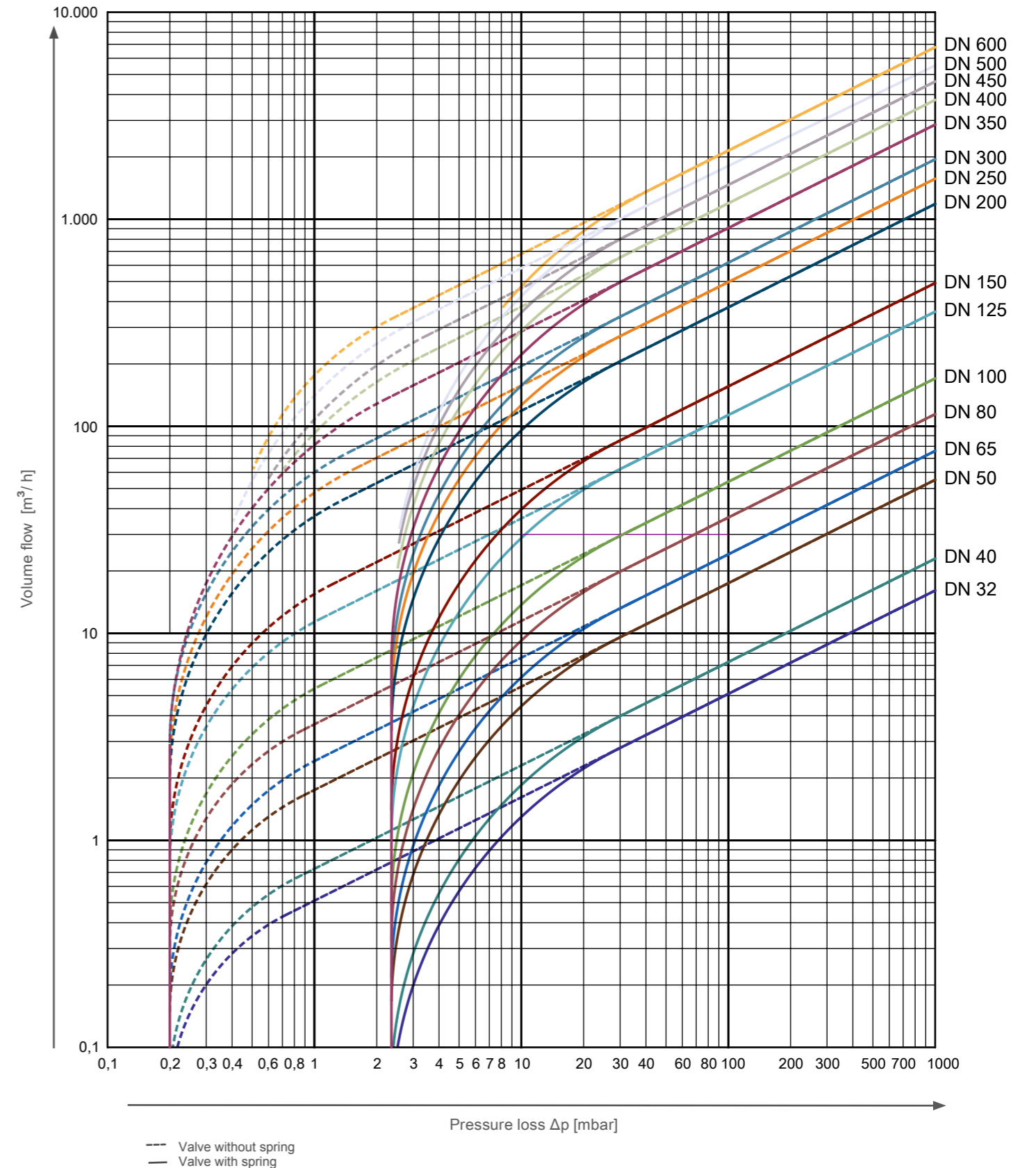

SPECIAL OPTIONS

SWING CHECK VALVES WAFER TYPE

With our many years of experience, and our understanding of the demands of the market and the constantly rising expectations of our customers, we always strive to develop and implement solutions that go well beyond the standard. Here are just a few examples of special designs that we have created either in-house, based on our standard models, or with the help of our long-standing pool of partners. Here we adhere to the criteria of technical and economic feasibility combined with a healthy dose of pragmatism.



With mounting holes



Lug type body



With manual override



With attached ground cable



Reinforced design with holding plates



Disc with integrated pressure relief valve

Other special options:

- Cleaned free of oil and grease
- Cleaned free of silicone
- Cleaned free of PWIS

- Seals with additional approvals which go beyond the standard
- With seal that is glued in for vacuum applications

- Other materials on request
- Other flange dimensions on request
- Other special options on request

TYPE CODE

SWING CHECK VALVES WAFER TYPE

QUALITY

AT AWS



Order example	ZRKF-VA-VA-100-N-F1
Type of valve	Swing check valve wafer type
Type	ZRKF
Nominal size	DN 100
Body / Disc	1.4408
Seal	NBR
Spring	Stainless steel 1.4571 (F1)

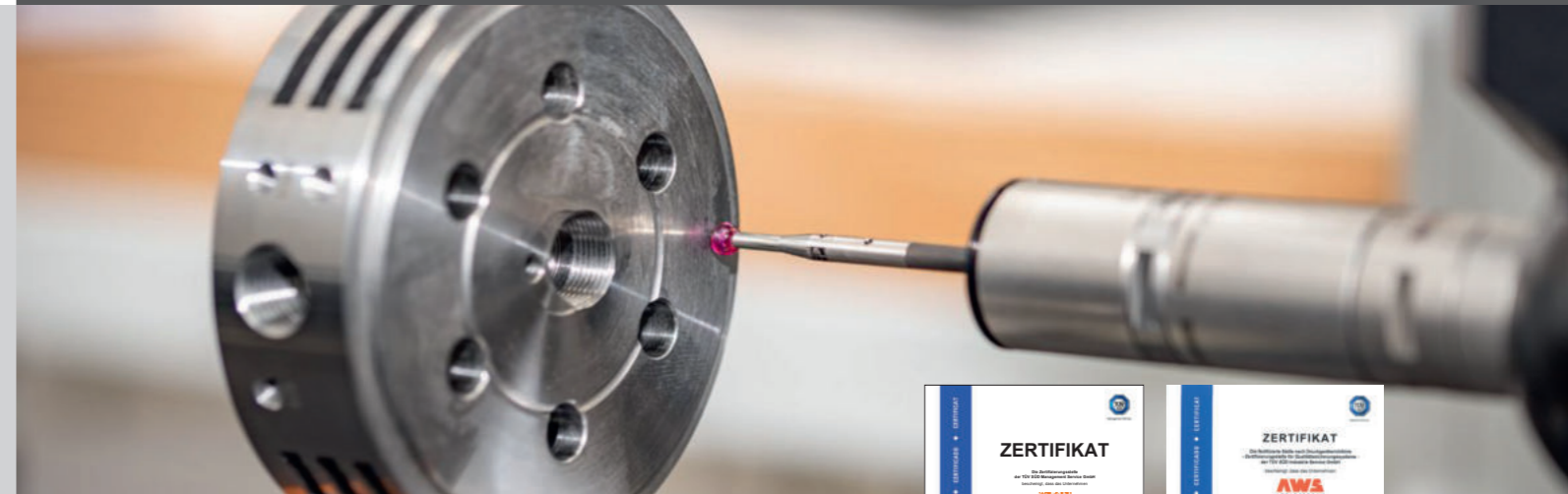

Type	DN		Material				Seal
	Nominal size	Design	Body	Disc	Spring		
ZRK	32 - 1200	ST-ST	1.0460, zinc plated	1.0619 / 1.0460, zinc plated			Metal seated (M)
		ST-VA	1.0460, zinc plated	1.4408			
		VA-VA	1.4408	1.4408			
		VA1-VA1	1.4571	1.4571			
		AB-DU	CC333G (2.0975)	1.4469 (Superduplex)			
		DU-DU	1.4469 (Superduplex)	1.4469 (Superduplex)			
ZRKF	32 - 400	ST-ST	1.0460, zinc plated	1.0619 / 1.0460, zinc plated	1.4571 (F1)*1		EPDM (E)
		ST-VA	1.0460, zinc plated	1.4408	1.4571 (F1)*1		FKM (F)
		VA-VA	1.4408	1.4408	1.4571 (F1)*1		PTFE (Teflon) (T)
		VA1-VA1	1.4571	1.4571	1.4571 (F1)*1		
		AB-DU	CC333G (2.0975)	1.4469 (Superduplex)	Hastelloy C4 (F2)		
		DU-DU	1.4469 (Superduplex)	1.4469 (Superduplex)	Hastelloy C4 (F2)		
920	32 - 600	4	PVC-U	PVC-U	1.4571 (F1), Hastelloy C4 (F2)*2		NBR (N)
		4.1	PVC-C	PVC-C	1.4571 (F1), Hastelloy C4 (F2)*2		EPDM (E)
		5	PP-H	PP-H	1.4571 (F1), Hastelloy C4 (F2)*2		FKM (F)
		8	PVDF	PVDF	1.4571 (F1), Hastelloy C4 (F2)*2		PTFE (Teflon) (T)
925.1	50 - 200	4	PVC-U	PVC-U			EPDM (E)

Certified

Our more than 40-year company history is characterised by our constant striving for the highest quality. As a modern and future-oriented group of companies, we have further optimised our flexible response to changing market conditions and customer requirements by introducing and applying a comprehensive quality management system.

For many years now, we have been certified in accordance with ISO 9001 and – in the field of valves – also in accordance with the Pressure Equipment Directive 2014/68/EU. Systematic quality checks are conducted throughout the entire process chain, from the receipt of the goods to the delivery of the products. Not least during the final inspection, state-of-the-art measuring methods (including 3D measuring machines and surface measuring devices for roughness, waviness and profile measurement) as well as pressure, tightness and vacuum tests both ensure and document that the required quality has been achieved.

*1 metal seated valves require spring material Hastelloy C4 (F2) for temperatures above 300°C

*2 for the choice of the appropriate spring material, the chemical resistance against the media has to be regarded

AWS PRODUCT OVERVIEW

EVERYTHING FROM A SINGLE SOURCE!



AWS Apparatebau has a wide and advanced product range. With many decades of experience as a manufacturer of check valves and in the field of valve technology, we are able to provide you with solutions for a variety of applications.

Industries that rely on our products include:

- Building technology
- Shipbuilding
- Chemistry and refining
- Water, waste water, water treatment, desalination
- Food and beverage industry
- Vacuum technology
- Aviation industry





AWS Apparatebau Arnold GmbH
Zimmerbachstraße 51
74676 Niedernhall - Waldzimmern
Tel.: +49 (0)7940 9308-200
info@aws-apparatebau.de
www.aws-apparatebau.de